

# IETF 91 HONOLULU, HI, USA

HILTON HAWAIIAN VILLAGE  
NOVEMBER 9 - 14, 2014

Version 00  
Updated 2014-11-06  
07:58 PDT



## Table of Contents

Area Directors .....	2
Registration .....	3
Badges and Dots.....	3
Terminal Room .....	3
Food & Beverage Service*.....	3
Lost and Found .....	3
Meeting Communication.....	4
Tuesday Night Social Event .....	4
Floor Plans .....	5
Note Well.....	9
Agenda of IETF 91, November 9-14, 2014 .....	9
IETF 91 Sponsors.....	14
Next Meeting: IETF 92 .....	15

## Area Directors

### Applications Area (APP)

Barry Leiba, Huawei Technologies  
 Pete Resnick, QTI, a Qualcomm Company

### General Area (GEN)

Jari Arkko, Ericsson

### Internet Area (INT)

Brian Haberman, Johns Hopkins University  
 Ted Lemon, Nominum, Inc.

### Operations and Management Area (OPS)

Benoit Claise, Cisco  
 Joel Jaeggli, Fastly

### Real-time Applications and Infrastructure Area (RAI)

Richard Barnes, Mozilla  
 Alissa Cooper, Cisco

### Routing Area (RTG)

Alia Atlas, Juniper Networks  
 Adrian Farrel, Juniper Networks

### Security Area (SEC)

Stephen Farrell, Trinity College Dublin  
 Kathleen Moriarty, EMC Corporation

### Transport Area (TSV)

Spencer Dawkins, Huawei  
 Martin Stiemmerling, Darmstadt University of Applied Sciences

## Registration

Location: Coral Lounge

DAY	HOURS
Sunday	1100 - 1900
Monday	0800 - 1800
Tuesday	0800 - 1800
Wednesday	0800 - 1700
Thursday	0800 - 1700
Friday	0800 - 1100

Note: To request a hard copy receipt, please send an email to [registrar@ietf.org](mailto:registrar@ietf.org) with the name on your registration or your registration number.

## Badges and Dots

Please wear your badge at all times.

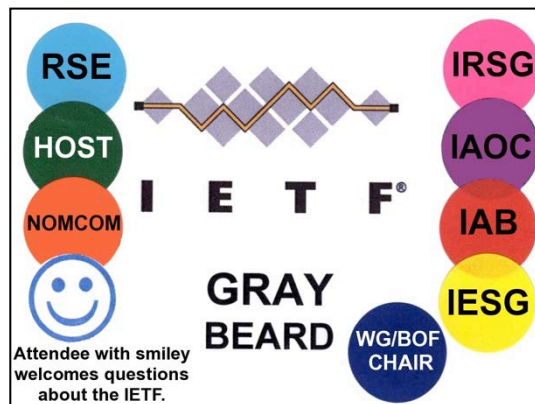

### Banner Key:

*Maroon Banner:*  
First-Time Attendee

*Orange Banner:*  
Press/Media

## Food & Beverage Service\*

Sunday Welcome Reception:  
1700 - 1900 on the Great Lawn

Beverage & Snack Service:  
Located in the Coral Lounge

DAY	TIME
Monday	<ul style="list-style-type: none"> <li>• 0800-0900 (Continental Breakfast)</li> <li>• 1500-1520 (Beverage Break)</li> <li>• 1830-1850 (Beverage &amp; Snack Break)</li> </ul>
Tuesday	<ul style="list-style-type: none"> <li>• 0800-0900 (Continental Breakfast)</li> <li>• 1500-1520 (Beverage &amp; Snack Break)</li> </ul>
Wednesday	<ul style="list-style-type: none"> <li>• 0800-0900 (Continental Breakfast)</li> <li>• 1500-1520 (Beverage Break)</li> <li>• 1650-1710 (Beverage &amp; Snack Break)</li> </ul>
Thursday	<ul style="list-style-type: none"> <li>• 0800-0900 (Continental Breakfast)</li> <li>• 1500-1520 (Beverage Break)</li> <li>• 1620-1640 (Beverage &amp; Snack Break)</li> </ul>
Friday	<ul style="list-style-type: none"> <li>• 0800-0900 (Continental Breakfast)</li> <li>• 1130-1150 (Beverage &amp; Snack Break)</li> </ul>

\*Lunch and dinner are not provided.

## Lost and Found

Please turn in all "found" items to the Registration Desk in the Coral Lounge. If you are missing an item, please stop by the registration desk or email [registrar@ietf.org](mailto:registrar@ietf.org) with a description of the item.

## Terminal Room

The Terminal Room will be in South Pacific 1. 24-hour access is available starting at 1600 Sunday, November 9 through 1500 Friday, November 14. *NOTE: IETF badge is required to enter the Terminal Room.*

## Meeting Communication

<p><b><u>Audio Streaming</u></b></p> <p>Audio streaming during the meeting can be accessed at:  <a href="http://ietf91streaming.dnsalias.net/ietf/">http://ietf91streaming.dnsalias.net/ietf/</a></p> <p>Following the meeting, the audio archives will be housed on the IETF website at:  <a href="http://www.ietf.org/audio/ietf91/">http://www.ietf.org/audio/ietf91/</a></p>	<p><b><u>Message Board</u></b></p> <p>This board is located near the Registration Desk. It contains important information such as agenda changes and messages to other attendees. Please do not post resumes, job openings, or solicitations of any kind.</p>	<p><b><u>Meeting Wiki</u></b></p> <p>A wiki of useful meeting-related information, including transportation information and dining suggestions can be found here:  <a href="http://www.ietf.org/registration/MeetingWiki/wiki/ietf91">http://www.ietf.org/registration/MeetingWiki/wiki/ietf91</a></p> <p>Contributions are welcomed at any time.</p>
<p><b><u>Meeting Mail Lists</u></b></p> <p><u>91ALL</u>            Everyone who has registered for the meeting is subscribed to 91ALL. The list is reserved for communication from the IETF Administrative Director (IAD) and the Secretariat. <b>Attendees cannot send to this list.</b></p> <p><u>91ATTENDEES</u>            This list is intended for community discussions during the meeting. All subscribers can send to this list. Subscribe and unsubscribe at  <a href="http://www.ietf.org/mailman/listinfo/91attendees">http://www.ietf.org/mailman/listinfo/91attendees</a>.</p>	<p><b><u>Jabber Rooms</u></b></p> <p>Jabber rooms are available for each session and use the name of the working group:  <b><a href="mailto:[wg]@jabber.ietf.org">[wg]@jabber.ietf.org</a></b></p> <p>Logging is automatically enabled in each room. The logs are located here:  <a href="http://jabber.ietf.org/logs/">http://jabber.ietf.org/logs/</a></p> <p>For more information about Jabber, see  <a href="http://www.jabber.org/">http://www.jabber.org/</a></p>	<p><b><u>Troubleshooting</u></b></p> <p>When reporting problems, please be as specific as possible in your message and remember to include the room name.</p> <p>For network connectivity and audio streaming issues, please contact <a href="mailto:noc@ietf.org">noc@ietf.org</a>.</p> <p>For all other meeting issues, including A/V and environmental issues (e.g. noise, temperature), please contact <a href="mailto:mtd@ietf.org">mtd@ietf.org</a>.</p>

## Tuesday Night Social Event



**Hosted by:** [Cisco](#)

**Location:** Great Lawn of the Hilton Hawaiian Village

**Date:** Tuesday, 11 November 2014

**Time:** 18:00 to 22:00

**Cost:** \$50 USD for the 1st ticket and \$100 USD for an additional ticket.

**Food and beverage:** Enjoy a family style dinner in the island tradition along with soft drinks and alcoholic beverages.

**More Info/Tickets:** <https://www.ietf.org/meeting/91/social.html>

## Floor Plans

### HILTON HAWAIIAN VILLAGE



#### MID-PACIFIC CONFERENCE

##### CENTER / KALIA TOWER:

- IETF Registration (Coral Lounge)
- Continental Breakfast & Breaks (Coral Lounge)
- Breakout Rooms
  - \* Coral 1
  - \* Coral 2
  - \* Coral 3
  - \* Coral 4
  - \* Coral 5
  - \* Hibiscus
  - \* Kahili
  - \* Lehua

- IAB Office (Sea Pearl 2)
- IAOC/IAD Office (South Pacific 3)
- ISOC Offices (Sea Pearl 3 & 4)
- Lounge (South Pacific 4)
- Secretariat Office (South Pacific Boardroom)
- Terminal Room (South Pacific 1)

##### TAPA TOWER:

- NomCom Office (Honolulu 1)

##### RAINBOW TOWER

- IESG Office (Rainbow Suite 1-2)

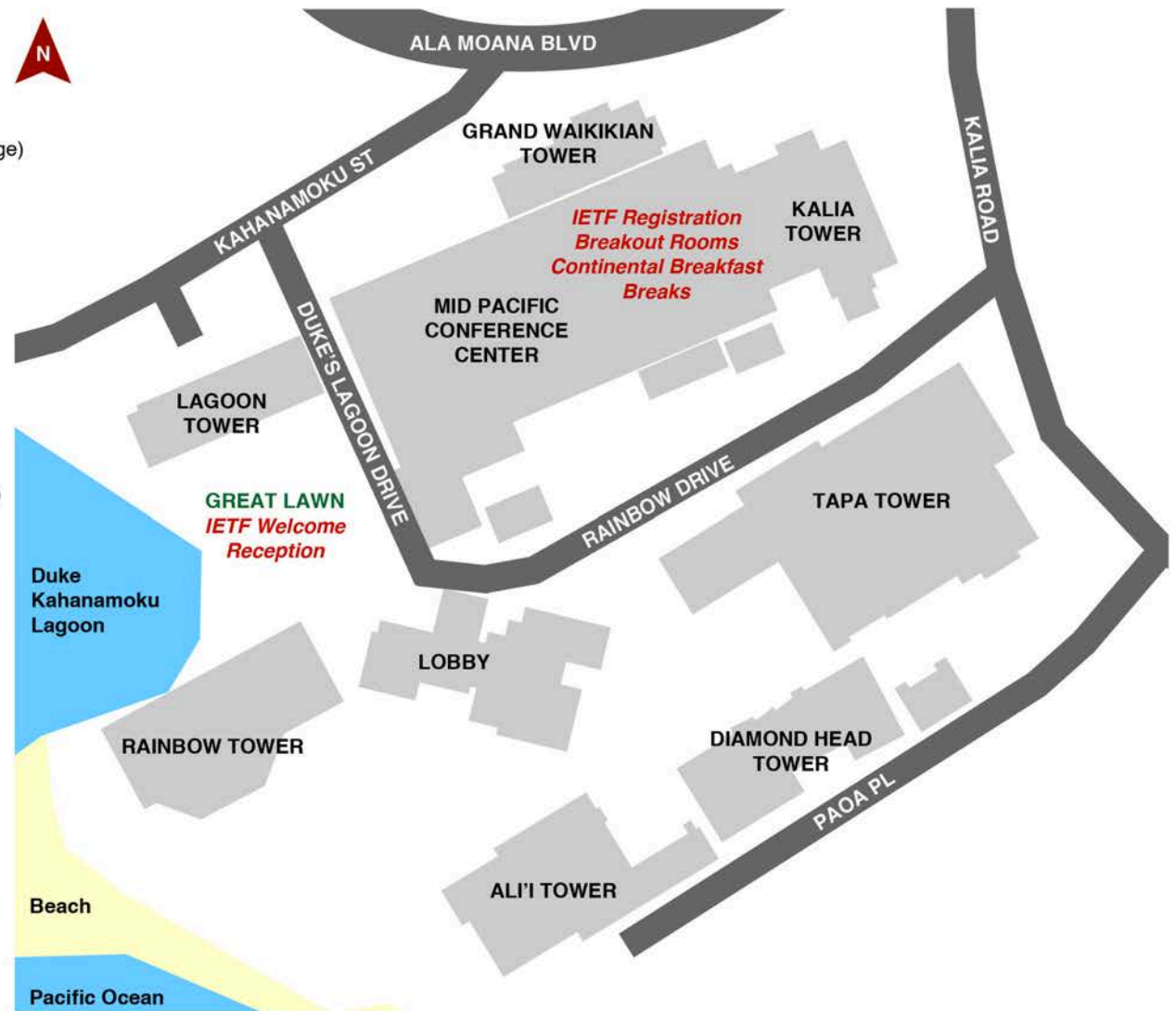

**Mid-Pacific Conference Center (6th Floor) & Kalia Executive Conference Center (2nd Floor)**

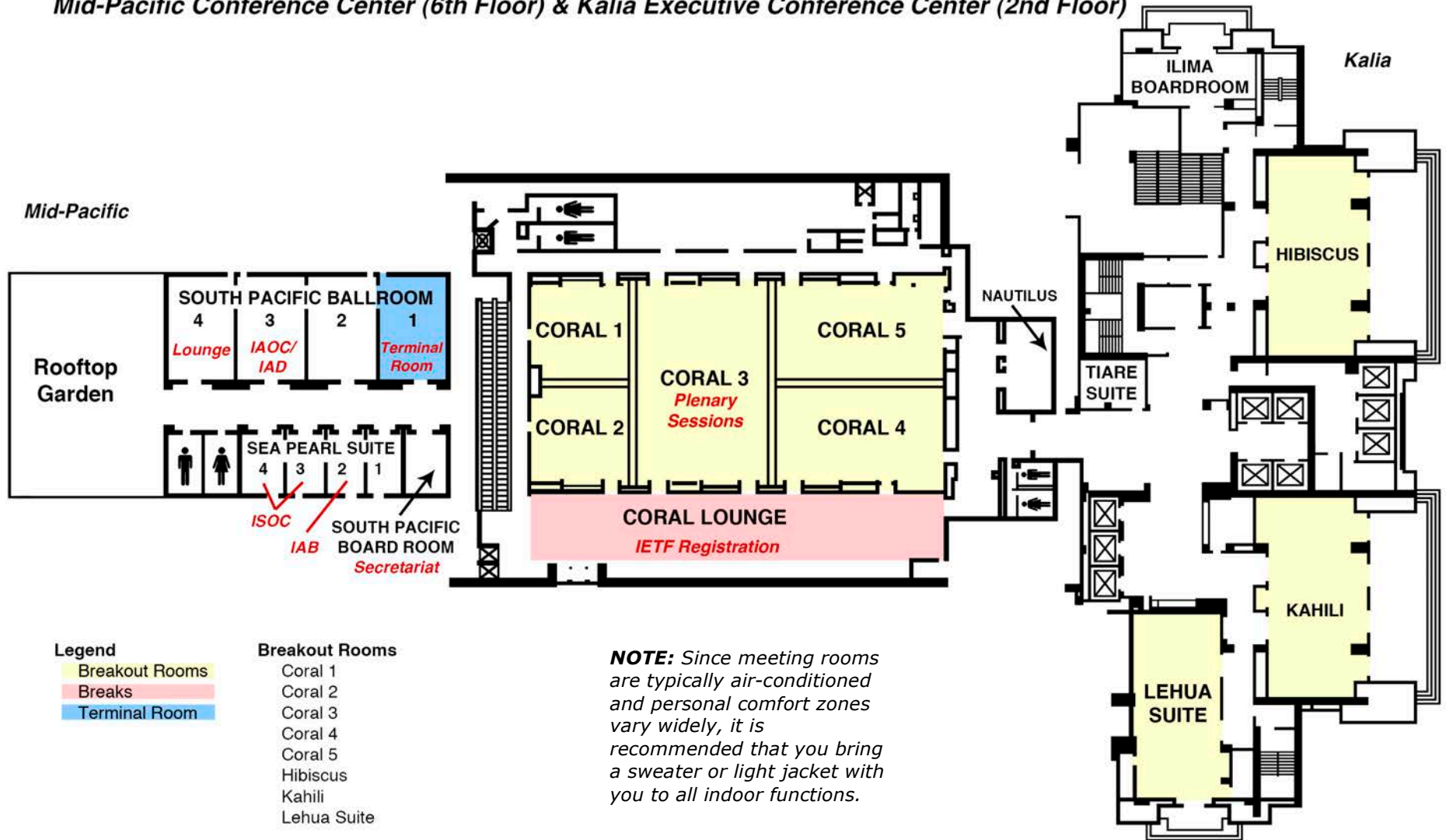

**Tapa Conference Center (2nd Floor)**

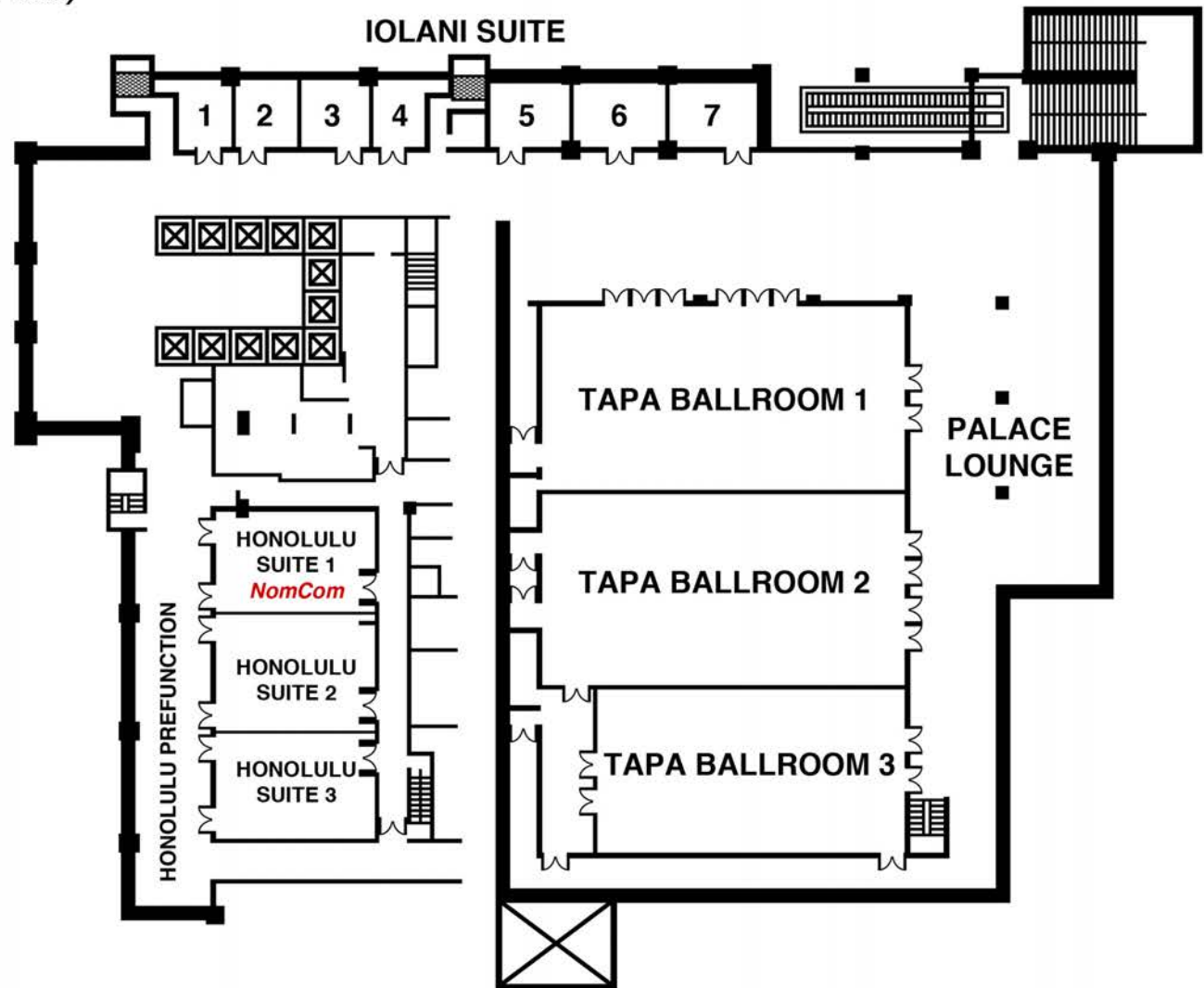

**NOTE:** Since meeting rooms are typically air-conditioned and personal comfort zones vary widely, it is recommended that you bring a sweater or light jacket with you to all indoor functions.

**Rainbow Suite**

**NOTE:** Since meeting rooms are typically air-conditioned and personal comfort zones vary widely, it is recommended that you bring a sweater or light jacket with you to all indoor functions.

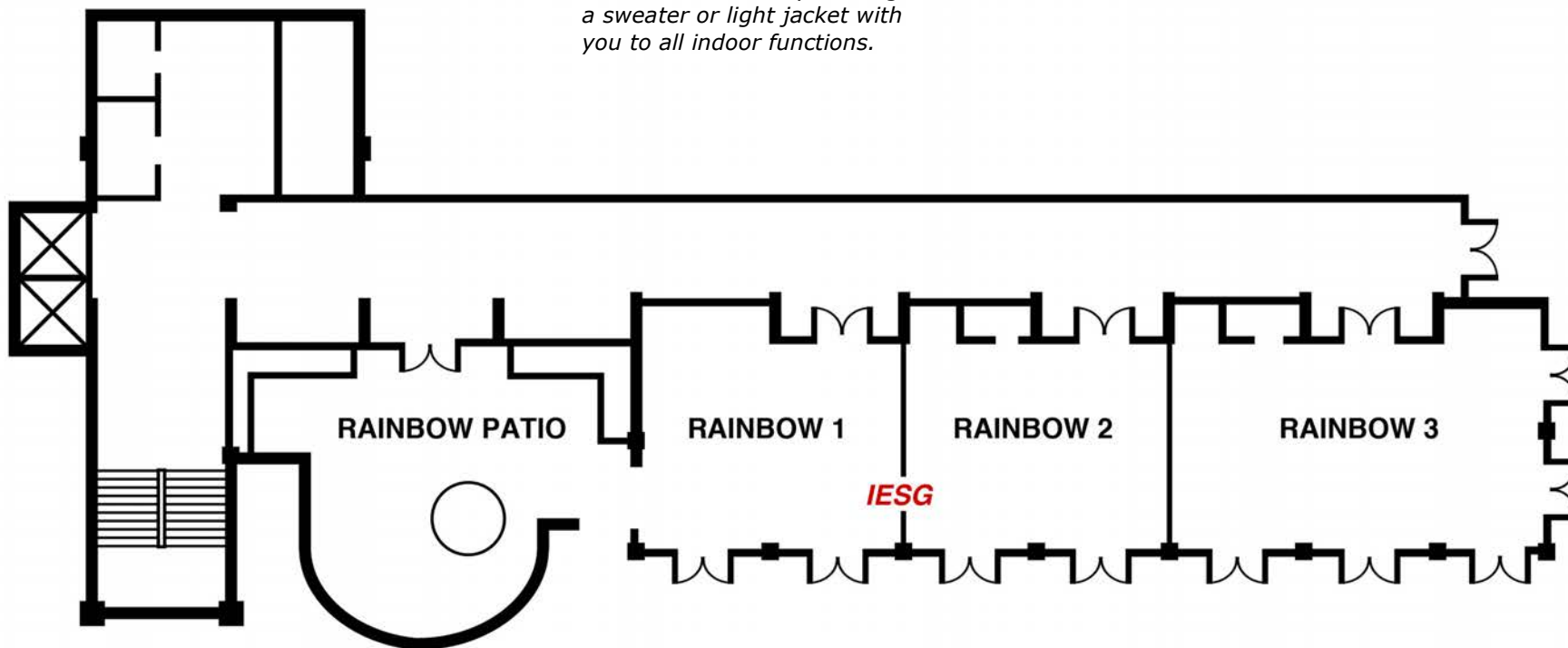

## Note Well

Any submission to the IETF intended by the Contributor for publication as all or part of an IETF Internet-Draft or RFC and any statement made within the context of an IETF activity is considered an "IETF Contribution". Such statements include oral statements in IETF sessions, as well as written and electronic communications made at any time or place, which are addressed to:

- The IETF plenary session
- The IESG, or any member thereof on behalf of the IESG
- Any IETF mailing list, including the IETF list itself, any working group or design team list, or any other list functioning under IETF auspices
- Any IETF working group or portion thereof
- Any Birds of a Feather (BOF) session
- The IAB or any member thereof on behalf of the IAB
- The RFC Editor or the Internet-Drafts function

All IETF Contributions are subject to the rules of [RFC 5378](#) and [RFC 3979](#) (updated by [RFC 4879](#)).

Statements made outside of an IETF session, mailing list or other function, that are clearly not intended to be input to an IETF activity, group or function, are not IETF Contributions in the context of this notice. Please consult [RFC 5378](#) and [RFC 3979](#) for details.

A participant in any IETF activity is deemed to accept all IETF rules of process, as documented in Best Current Practices RFCs and IESG Statements.

A participant in any IETF activity acknowledges that written, audio and video records of meetings may be made and may be available to the public.

**Updated 2014-11-05 12:10:59 PDT**

*IETF agendas are subject to change, up to and during the meeting.*

## Agenda of IETF 91, November 9-14, 2014

*New additions to a meeting slot are marked in blue.*

*All other agenda changes are marked in red.*

### SATURDAY, November 8, 2014

0930-1800 Code Sprint – South Pacific 1

### SUNDAY, November 9, 2014

1000-1200 IEPG Meeting - Coral 2

1100-1900 IETF Registration - Coral Lounge

1300-1450 Introduction to the Security Area - Coral 2

1300-1450 Newcomers' Orientation - Coral 1

1400-1700 Yang Advice and Editing Session - Lehua Suite

1500-1650 Presentation Skills - Coral 1

1600-1700 Newcomers' Meet and Greet (open to Newcomers and WG chairs only) - Rainbow Suite

1700-1900 Welcome Reception - Great Lawn

## MONDAY, November 10, 2014

0800-1800 IETF Registration – Coral Lounge

0800-0900 Continental Breakfast – Coral Lounge

### 0900-1130 Morning Session I

Coral 2	APP	appsawg	Applications Area - Combined with APPAREA
Coral 3	IRTF	sdnrg	Software Defined Networking Research Group
Coral 4	OPS	v6ops	IPv6 Operations
Lehua Suite	RAI	avtcore	Audio/Video Transport Core Maintenance
Coral 5	RTG	mpls	Multiprotocol Label Switching - 09:00-10:30
Coral 5	RTG	pce	Path Computation Element - 10:30-11:30
Coral 1	RTG	sidr	Secure Inter-Domain Routing
Kahili	SEC	sacm	Security Automation and Continuous Monitoring
Hibiscus	TSV	tcpm	TCP Maintenance and Minor Extensions

1130-1300 Break

### 1300-1500 Afternoon Session I

Coral 3	GEN	ianaplan	Planning for the IANA/NTIA Transition
Lehua Suite	INT	pcp	Port Control Protocol
<del>Kahili</del>	<del>RAI</del>	<del>ecrit</del>	<del>Emergency Context Resolution with Internet Technologies</del> - Moved to Thursday 1300
Coral 4	RTG	bier	Bit Indexed Explicit Replication BOF
Hibiscus	SEC	mile	Managed Incident Lightweight Exchange
Coral 2	TSV	aqm	Active Queue Management and Packet Scheduling
Coral 1	TSV	cdni	Content Delivery Networks Interconnection

1500-1520 Beverage Break - Coral Lounge

### 1520-1720 Afternoon Session II

Lehua Suite	APP	eppext	Extensible Provisioning Protocol Extensions
Coral 1	INT	detnet	Deterministic Networking BOF
Kahili	IRTF	icnrg	Information-Centric Networking
Coral 5	OPS	anima	Autonomic Networking Integrated Model and Approach BoF
Coral 3	OPS	v6ops	IPv6 Operations
Coral 4	RAI	rtcweb	Real-Time Communication in WEB-browsers
Coral 2	RTG	nvo3	Network Virtualization Overlays
Hibiscus	SEC	trans	Public Notary Transparency

### 1730-1830 Afternoon Session III

Kahili	IRTF	icnrg	Information-Centric Networking
Coral 5	OPS	anima	Autonomic Networking Integrated Model and Approach BoF
Coral 4	OPS	grow	Global Routing Operations
Coral 2	RTG	nvo3	Network Virtualization Overlays
Coral 1	SEC	dice	DTLS In Constrained Environments
Lehua Suite	SEC	jose	Javascript Object Signing and Encryption - Moved from South Pacific 2
Hibiscus	SEC	trans	Public Notary Transparency

1830-1850 Beverage & Snack Break - Coral Lounge

### 1850-1950 Technical Plenary - Coral 3

1. Welcome
2. Reporting: IAB Chair, IRTF Chair, RSE and RSOC Chair
3. Highlight Two IAB Programs – IP Stack Evolution, Privacy and Security
4. IAB Open Mic

## TUESDAY, November 11, 2014

0800-1800 IETF Registration - Coral Lounge

0800-0900 Continental Breakfast - Coral Lounge

### 0900-1130 Morning Session I

Coral 2	APP	uta	Using TLS in Applications
Kahili	INT	6lo	IPv6 over Networks of Resource-constrained Nodes
Coral 4	IRTF	irtfopen	IRTF Open Meeting
Lehua Suite	OPS	dime	Diameter Maintenance and Extensions
Hibiscus	OPS	mboned	MBONE Deployment
Coral 1	RAI	dispatch	Dispatch
Coral 1	RAI	siprec	SIP Recording
Hibiscus	RTG	pim	Protocol Independent Multicast
Coral 3	RTG	sfc	Service Function Chaining

~~Coral 5~~ ~~TSV~~ ~~tsvarea~~ ~~Transport Area Open Meeting~~

- CANCELLED

1130-1300 Break

### 1300-1500 Afternoon Session I

Coral 1	APP	httpbis	Hypertext Transfer Protocol
Coral 5	INT	dprive	DNS PRIVate Exchange
Coral 3	INT	softwire	Softwires WG
Hibiscus	IRTF	dclcr	Proposed Data Center Latency Control RG
Lehua Suite	OPS	netconf	Network Configuration
Kahili	RAI	stir	Secure Telephone Identity Revisited
Coral 4	RTG	rtgarea	Routing Area Open Meeting
Coral 2	TSV	taps	Transport Services

- Moved from Thursday at 0900

1500-1520 Beverage & Snack Break - Coral Lounge

### 1520-1720 Afternoon Session II

Coral 2	APP	core	Constrained RESTful Environments
Coral 1	IRTF	iccr	Internet Congestion Control Research Group
Coral 4	OPS	dnsop	Domain Name System Operations
Lehua Suite	OPS	radext	RADIUS EXTensions
Kahili	RAI	avtext	Audio/Video Transport Extensions
Coral 5	RAI	webpush	Web-Based Push Notifications
Coral 3	RTG	actn	Abstraction and Control of Transport Networks BOF
Hibiscus	TSV	ippm	IP Performance Metrics

## WEDNESDAY, November 12, 2014

0800-1700 IETF Registration - Coral Lounge

0800-0900 Continental Breakfast - Coral Lounge

### 0900-1130 Morning Session I

Kahili	APP	core	Constrained RESTful Environments
Hibiscus	INT	dmm	Distributed Mobility Management
Coral 3	INT	homenet	Home Networking
Coral 1	OPS	opsawg	Operations and Management Area Working Group
- Combined with OPSAREA			
Coral 5	RTG	bess	BGP Enabled Services
Coral 2	RTG	rtgwg	Routing Area Working Group
Lehua Suite	SEC	oauth	Web Authorization Protocol
Coral 4	TSV	rmcat	RTP Media Congestion Avoidance Techniques

1130-1300 Break

### 1300-1500 Afternoon Session I

Coral 2	INT	mif	Multiple Interfaces
Kahili	RAI	clue	ControLling mUltiple streams for tElepresence
<del>Coral 4</del>	<del>RTG</del>	<del>l2vpn</del>	<del>Layer 2 Virtual Private Networks WG</del>
- CANCELLED			
Coral 4	RTG	pals	Pseudowire And LDP-enabled Services
Lehua Suite	RTG	ospf	Open Shortest Path First IGP
Coral 5	SEC	ace	Authentication and Authorization for Constrained Environments
Coral 3	SEC	dane	DNS-based Authentication of Named Entities
Hibiscus	TSV	ppsp	Peer to Peer Streaming Protocol
Coral 1	TSV	tram	TURN Revised and Modernized

1500-1520 Beverage Break - Coral Lounge

### 1520-1650 Afternoon Session II

Coral 4	APP	httpbis	Hypertext Transfer Protocol
Lehua Suite	INT	ntp	Network Time Protocol
- Combined with TICTOC			
Lehua Suite	INT	tictoc	Timing over IP Connection and Transfer of Clock
- Combined with NTP			
Kahili	INT	trill	Transparent Interconnection of Lots of Links
Hibiscus	RAI	straw	Sip Traversal Required for Applications to Work
Coral 2	RAI	xrblock	Metric Blocks for use with RTCP's Extended Report Framework
Coral 1	RTG	bfd	Bidirectional Forwarding Detection
Coral 5	TSV	dtn	Delay Tolerant Networking

1650-1710 Beverage & Snack Break - Coral Lounge

### 1710-1940 IETF Operations and Administration Plenary - Coral 3

## THURSDAY, November 13, 2014

0800-1700 IETF Registration - Coral Lounge

0800-0900 Continental Breakfast - Coral Lounge

### 0900-1130 Morning Session I

Hibiscus	INT	6tisch	IPv6 over the TSCH mode of IEEE 802.15.4e
Coral 4	IRTF	nfvrg	Proposed Network Function Virtualization Research Group
Kahili	OPS	lmap	Large-Scale Measurement of Broadband Performance
Coral 1	RAI	mmusic	Multiparty Multimedia Session Control
Lehua Suite	RTG	manet	Mobile Ad-hoc Networks
Coral 3	RTG	spring	Source Packet Routing in Networking
Coral 5	SEC	tls	Transport Layer Security
Coral 2	TSV	tsvwg	Transport Area Working Group

- Moved from Tuesday at 1300

1130-1300 Break

1200-1245 Thursday Lunch Speaker Series - Coral 2

### 1300-1500 Afternoon Session I

Coral 4	INT	dnssd	Extensions for Scalable DNS Service Discovery
Coral 2	OPS	lime	Layer Independent OAM Management in the Multi-Layer Environment
<del>Coral 5</del>	<del>RAI</del>	<del>netvc</del>	<del>Internet Video Codec BOF</del>
Lehua Suite	RAI	ecrit	Emergency Context Resolution with Internet Technologies

- Moved from Monday 1300

Kahili	RTG	idr	Inter-Domain Routing
Coral 3	SEC	saag	Security Area Open Meeting

Coral 1	TSV	tsvwg	Transport Area Working Group
---------	-----	-------	------------------------------

1500-1520 Beverage Break - Coral Lounge

### 1520 - 1620 Afternoon Session II

Coral 2	APP	arcmedia	Archive Top Level Media Type BOF
Coral 4	INT	lwig	Light-Weight Implementation Guidance
<del>Coral 5</del>	<del>OPS</del>	<del>opsec</del>	<del>Operational Security Capabilities for IP Network Infrastructure</del>
			- CANCELLED
Kahili	RAI	sipcore	Session Initiation Protocol Core
Coral 3	RTG	i2rs	Interface to the Routing System
Coral 1	SEC	ipsecme	IP Security Maintenance and Extensions
Hibiscus	SEC	kitten	Common Authentication Technology Next Generation
Lehua Suite	TSV	conex	Congestion Exposure

1620-1640 Beverage & Snack Break - Coral Lounge

### 1640-1910 Afternoon Session III

Kahili	INT	dhc	Dynamic Host Configuration
Coral 2	INT	lisp	Locator/ID Separation Protocol
Lehua Suite	OPS	bmwg	Benchmarking Methodology
Coral 4	OPS	netmod	NETCONF Data Modeling Language
Coral 3	RAI	rtcweb	Real-Time Communication in WEB-browsers
Coral 5	RTG	ccamp	Common Control and Measurement Plane
Coral 1	SEC	i2nsf	Interface to Network Security Functions BOF
Hibiscus	TSV	alto	Application-Layer Traffic Optimization

**FRIDAY, November 14, 2014**

0800-1100 IETF Registration - Coral Lounge  
 0800-0900 Continental Breakfast - Coral Lounge

**0900-1130 Morning Session I**

Hibiscus	APP	dmarc	Domain-based Message Authentication, Reporting & Conformance
<b>09:00-10:00</b>			
Hibiscus	APP	precis	Preparation and Comparison of Internationalized Strings -
<b>10:30-11:30</b>			
Coral 3	INT	6man	IPv6 Maintenance
Lehua Suite	IRTF	nwcrg	Network Coding Research Group
Coral 5	RAI	mmusic	Multiparty Multimedia Session Control
Coral 2	RTG	idr	Inter-Domain Routing WG
Coral 4	RTG	mpls	Multiprotocol Label Switching
Kahili	SEC	sacm	Security Automation and Continuous Monitoring

Coral 1 TSV tcpinc TCP Increased Security WG

1130-1150 Beverage & Snack Break - Coral Lounge

**1150-1320 Afternoon Session I**

Hibiscus	APP	scim	System for Cross-domain Identity Management
Coral 4	INT	intarea	Internet Area Working Group
Coral 3	OPS	netmod	NETCONF Data Modeling Language
Lehua Suite	RAI	clue	ControLLing mUltiple streams for tElepresence
Coral 5	RTG	isis	IS-IS for IP Internets WG
<del>Kahili</del>	<del>RTG</del>	<del>pwe3</del>	<del>Pseudowire Emulation Edge to Edge</del>
- CANCELLED			
Kahili	RTG	bess	BGP Enabled Services
Coral 2	SEC	httpauth	Hypertext Transfer Protocol Authentication
Coral 1	TSV	mptcp	Multipath TCP WG

**IETF 91 Sponsors**

Hosted By:



Connectivity Sponsor:



Beverage Break Sponsors:



Welcome Reception Sponsor:



## Next Meeting: IETF 92

### IETF 92: Dallas, Texas, USA March 22-27, 2015

Hosted by:



### Interested in hosting an IETF?

The IAOC makes decisions about IETF meeting location and venue based on a number of factors, including host preferences, the availability of sponsors, availability and pricing of venues, and more. If you have an idea for a meeting location, or are interested in sponsoring a meeting, please contact Drew Dvorshak at [dvorshak@isoc.org](mailto:dvorshak@isoc.org).

<b>Important Dates for IETF 92 -- DATES PROPOSED AND UNCONFIRMED</b>	
<b>Week of</b>	
<b>2015-01-05:</b>	IETF Online Registration opens.
<b>2015-01-05:</b>	Working Group and BOF scheduling begins.
<b>2015-02-06:</b>	Cutoff date for requests to schedule Working Group meetings at 2359 UTC.
<b>2015-02-06:</b>	Cutoff date for BOF proposal requests to Area Directors at 2359 UTC.
<b>2015-02-13:</b>	Cutoff date for Area Directors to approve BOFs at 2359 UTC.
<b>2015-02-20:</b>	Preliminary agenda published for comment.
<b>2015-02-25:</b>	Cutoff date for requests to reschedule Working Group and BOF meetings 2359 UTC.
<b>2015-02-27:</b>	Final agenda to be published.
<b>2015-03-09:</b>	Internet Draft submission cut-off (for all drafts, including -00) by 2359 UTC.
<b>2015-03-09:</b>	Draft Working Group agendas due by 2359 UTC.
<b>2015-03-13:</b>	Early Bird registration and payment cut-off at 2359 UTC.
<b>2015-03-16:</b>	Revised Working Group agendas due by 2359 UTC.
<b>2015-03-16:</b>	Registration cancellation cut-off at 2359 UTC.
<b>2015-03-20:</b>	Final Pre-Registration and Pre-Payment cut-off at 1700 local meeting time.
<b>2015-03-22 - 2015-03-27: 92nd IETF Meeting in Dallas, TX, USA.</b>	
<b>2015-04-17:</b>	Proceedings submission cutoff date by 2359 UTC.
<b>2015-05-11:</b>	Proceedings submission corrections cutoff date by 2359 UTC.